

Tub Spouts and Adapters

Surtidores para Bañeras y Adaptadores

RP17453▲

Standard pull-down diverter spout
6" total length
Sweat onto 1/2" C.W.T.
Thread onto 1/2" I.P.S. nipple
Non-metallic
RP12307 adapter assembly included

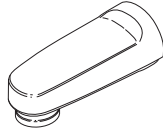

RP5836

Slip-on pull-down diverter spout
6" total length
Slip onto 1/2" C.W.T.
Non-metallic
RP33794 adapter assembly included

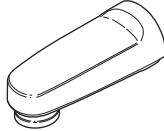

RP17454▲

Standard pull-down diverter spout
6" total length
Sweat onto 1/2" C.W.T.
Thread onto 1/2" I.P.S. nipple
Metal
RP12307 adapter assembly included

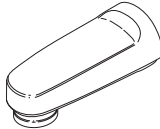

RP3914

Hand shower diverter spout for tub valves only
5" total length - Pull-out to divert
Thread onto 1/2" or 3/4" I.P.S.
Metal

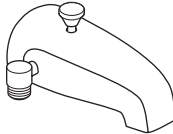

RP19820

Slip-On diverter spout
5 1/2" total length.
Pull-up to divert
Slip onto 1/2" C.W.T.
Non-metallic
RP33794 adapter assembly included

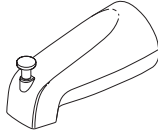

RP5834

Standard diverter spout
5 1/2" total length
Pull-up to divert
Sweat onto 1/2" C.W.T.
Thread onto 1/2" I.P.S.
Non-metallic
RP12307 adapter assembly included

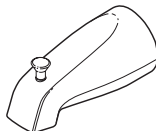

RP19895

Standard diverter spout
5 1/2" total length
Threads in nose of spout
Pull-up to divert
Thread onto 1/2" I.P.S. nipple
Metal

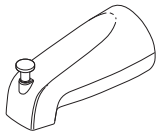

RP34357▲

Traditional diverter
7 1/2" total length
Pull-up to divert
Sweat onto 1/2" C.W.T.
Thread onto 1/2" I.P.S. nipple
50/50
RP12307 adapter assembly included



RP38449▲

Botanical™ diverter spout
6 1/2" total length
Pull-up to divert
Sweat onto 1/2" C.W.T.
Thread onto 1/2" I.P.S. nipple
50/50
RP12307 adapter assembly included

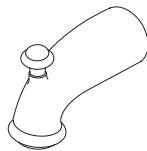

RP38450▲

Botanical™ diverter spout
7 5/8" total length
Pull-up to divert
Sweat onto 1/2" C.W.T.
Thread onto 1/2" I.P.S. nipple
50/50
RP12307 adapter assembly included



RP40625▲

Michael Graves Collection™
Diverter spout
7" total length
Pull-up to divert
Sweat onto 1/2" C.W.T.
Thread onto 1/2" I.P.S. nipple
Non-metallic
RP12307 adapter assembly included

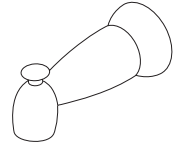

RP36497▲

Slip-on diverter spout
7" total length
Pull-up to divert
Slip onto 1/2" C.W.T.
Metal

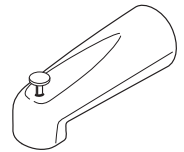

RP36498▲

Slip-on non-diverter spout
7" total length
Slip onto 1/2" C.W.T.
Metal

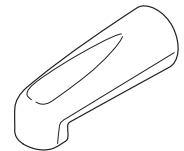

RP18396▲

Roman Tub spout
Wall mount
9" total length
Thread onto 1/2" I.P.S. nipple
Metal

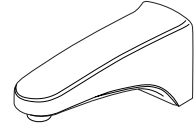

RP5835

Slip-on non-diverter spout
5 1/4" total length
Slip onto 1/2" C.W.T.
Metal

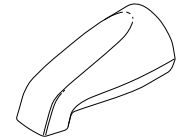

RP5833▲

Non-diverter spout
5 1/4" total length
Thread onto 1/2" I.P.S. nipple
Threads in nose of spout
Metal



RP12307

Adapter Assembly -
sweat onto 1/2" C.W.T.
or thread onto 1/2" I.P.S.

RP1745
O-Ring

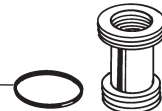

RP33794

Adapter Assembly - slip onto 1/2" C.W.T.

RP33482
Inside O-Ring

RP1745
Outside O-Ring

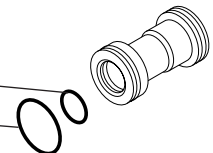

RP17472

Removable Decal for Pull-Down
Spout Operation

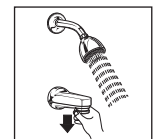

RP17829

Wall Decal-Pull-Down Diverter
Tub Spout Operation

