



ENGINEERED PRODUCTS CO.

LIGHTING PRODUCTS

T8 and T5 RETROFIT KITS

Retrofit Conversion Kit Installation Instructions

T8 and T5 RetroFit Conversion Kits - Installation Instructions for Part Numbers: 14050 and 14050B, 14051 and 14051B, 14055, 14056, 14057, 14060, 14065, 14066, 14067, 14070, 14071, 14076, 14077, and 14090.

Description: Converts older 4-foot and 8-Foot T8 or T12 strip light fixtures into energy efficient T8 or T5 light fixtures. The Kit Includes T8 or T5 Bi-Pin Lamp Sockets, Retrofit Bracket Socket Plates, and Self-Tapping Screws.

This Instruction Sheet also includes the installation of the Ballast Cover (Part Number 14080), the 6-inch and 10-inch White Reflectors (Part Numbers 14091 and 14095) or the 6-inch and 10-inch Specular Reflectors (Part Numbers 14092 and 14096).

Note: 1. EPCO's T8 and T5 RetroFit Conversion Kits only accommodate fixture housings between 4.25" and 5.0" wide!
2. The T8 RetroFit Conversion Kits use Instant-Start Ballast only! The exception are part numbers 14070 and 14076 that use

CAUTION

Installation of EPCO's T8 or T5 RetroFit Conversion Kits should only be used in conjunction with electrical wiring that is in good working order and that meets all applicable codes and ordinances.



DANGER – RISK OF FIRE OR ELECTRIC SHOCK!

Ballast, wiring, or other electrical parts may be damaged during drilling and/or installation of retrofit components.

All EPCO T8 or T5 RetroFit Conversion Kits must be installed by a Qualified Electrician!

1. Remove the existing fluorescent lamps from the light fixture. Recycle them at your local Recycling Service Center.
2. Remove and set aside the existing ballast cover(s) if you intend to re-use them. If not, recycle them at your local Recycling Service Center. Remove the existing lamp socket plates. If the socket plates are attached to the lighting fixture's end caps, separate them from the end caps and set the end caps aside.
3. Disconnect the incoming supply conductors. Remove the existing ballast.
4. Reversing the order of the removal instructions completes the installation of the new electronic ballast.

Note: In some cases the original ballast mounting holes may not line up with the new ballast. New holes may have to be drilled into the fixture housing to secure the ballast in its new location.

5. For 8-foot strip light fixtures the RetroFit Socket Plates are divided into three (3) sections; two (2) end sections and one (1) center section. Bend the end and center sections on the Retrofit Socket Plate back and forth until they separate. Follow this same procedure for the opposite end of the center section. See Figure 1.
6. Bend the flexible tabs of all three sections of the Retrofit Socket Plate approximately 90 degrees. See Figure 2.

Note: Check the width of the fixture housing! If the Fixture Housing is 4 inches wide, bend the socket plate as shown in Figure 3. If the Fixture Housing is 5 inches wide, bend the Socket Plate at the points shown in Figure 3.

7. Before installing the two (2) end sections and one (1) center section onto the 8-foot strip light fixture, it is recommended that you first pre-wire the lamp holders that are installed in the socket plate to the ballast conductors.

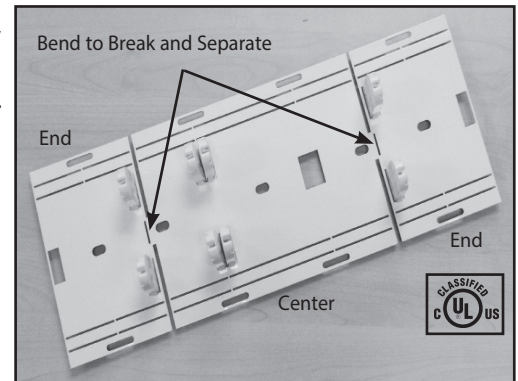

Figure 1. Preparing the Retrofit Socket Plate for Installation.

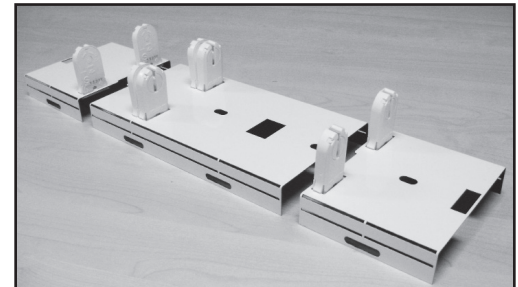

Figure 2. Bend the flexible tabs on the Retrofit Socket Plate 90 Degrees.

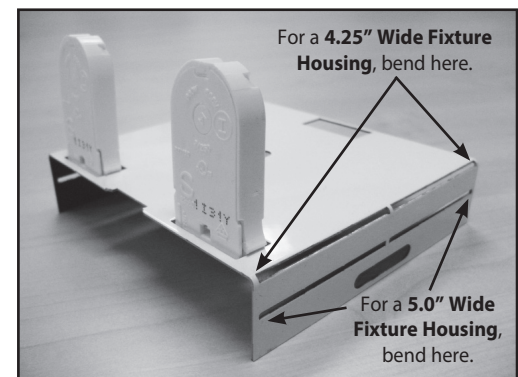

Figure 3. Retrofit Socket Plate for Installation on a 4.25" wide Fixture Housing.

Note: T8 and T5 Ballast terminations from each manufacturer are different! The T8 Retrofit Conversion Kit can only be used with an Instant Start Ballast! The exception are T8 Retrofit Conversion Kit part numbers 14070, 14071, 14076, and 14077 that use Programmed Start Ballast. Consult the wiring diagram on the T8 Ballast to ensure the correct connections are accurate from the ballast leads to the lamp manufacturer's ballast warranty.

8. When you have connected the respective conductors from the T8 or T5 ballast to the socket plates, you are ready to install the two (2) end sections and one (1) center section socket plate to the light fixture housing. Starting at one end of the housing, invert the end socket plate and push it up and into the location on the fixture housing where the original socket plate was removed. Make sure that you have placed socket plate to the outermost edge on the fixture housing to accommodate the length of the fluorescent lamps.

Note: If you are installing the Retrofit Conversion Kit on a 4-foot light fixture (P/Ns 14065, 14067, 14076, or 14090), you only need to install the two (2) end sections.

9. Secure the end socket plate using the self-tapping screws (supplied) in the slotted holes. If necessary, re-install the end cap into the existing holes on the fixture housing.

Note: Some fixture housings may require you to invert the original fixture housing's end cap 180 degrees and "possibly" drill new mounting holes so that it will fit and accommodate the left and right Socket Plates.

10. Dress the wires and push them up and into the fixture housing. Conductors should be reliably positioned away from all bracket mounting (self-drilling) screws. Follow this same procedure for the opposite end of the fixture housing.

Note: Step 11 does not apply when retrofitting 4-foot light fixtures!

11. To install the center section, find the center of the light fixture. Place a mark approximately 48 inches from the left or right end of the fixture. When you have located the center of the fixture housing, install the center section socket plate. Align the center section socket plate over the 48-inch mark using the two (2) lamp. Secure the center section socket plate using the self-tapping screws (included) through the slotted holes.

Note: Engineered Products Company recommends that you install a "Luminaire Disconnect" that is color-coded for the incoming "Black" and "White" supply conductors. The Luminaire Disconnect is not included in any EPCO Retrofit Conversion Kit and must be purchased separately from your local Electrical Distributor.

Optional: If you installing the Ballast Cover, the 6-inch or the 10-inch White Reflector or Specular Reflectors, continue to step 13.

12. Dress the remaining wires and push them up and into the fixture housing. Conductors should be reliably positioned away from all bracket mounting (self-drilling) screws.

13. Install the two (2) new Ballast Covers or the "White" or "Specular" Reflectors. Installation of each Ballast Cover or Reflector requires two (2) 1/4 Turn Retainer Clips. At each end of the Ballast Cover or Reflector there is a 1/2" (12.7mm) round hole. Start at the one side of the fixture housing, place the 1/2" hole on the Ballast Cover over the slotted hole on the end socket plate, insert one (1) 1/4 Turn Retainer Clip through the Ballast Cover and socket plate holes, then rotate the Retainer Clip one quarter turn to attach the Ballast Cover or Reflector. See Figures 5 and 5a. Follow the same procedure on the opposite end of the Ballast Cover or Reflector.

14. Re-lamp the light fixture with new T8 or T5 lamps and restore the power.

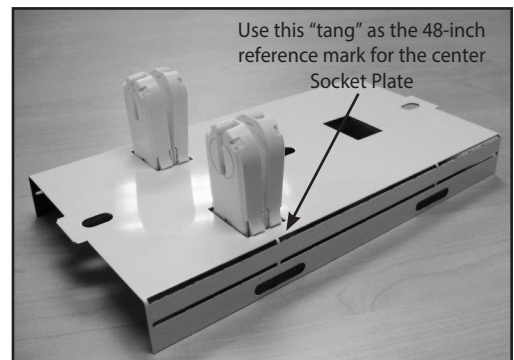

Figure 4. Locate the Retrofit "Center" Socket Plate on the 8-foot Fixture Housing.

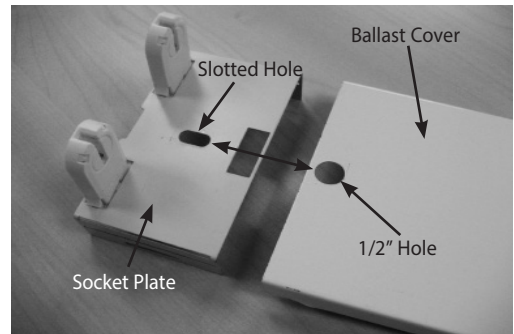

Figure 5. Align the slotted hole on the left-side Socket Plate to the 1/2" hole on the Ballast Cover.

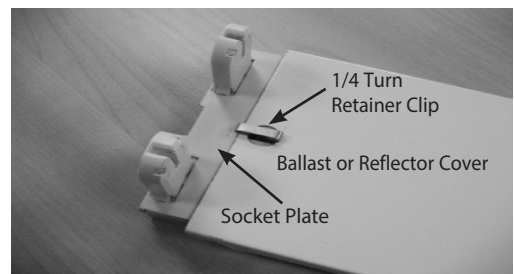

Figure 5a. Connect the end of the Socket Plate to the Ballast Cover using the Retainer Clip.